

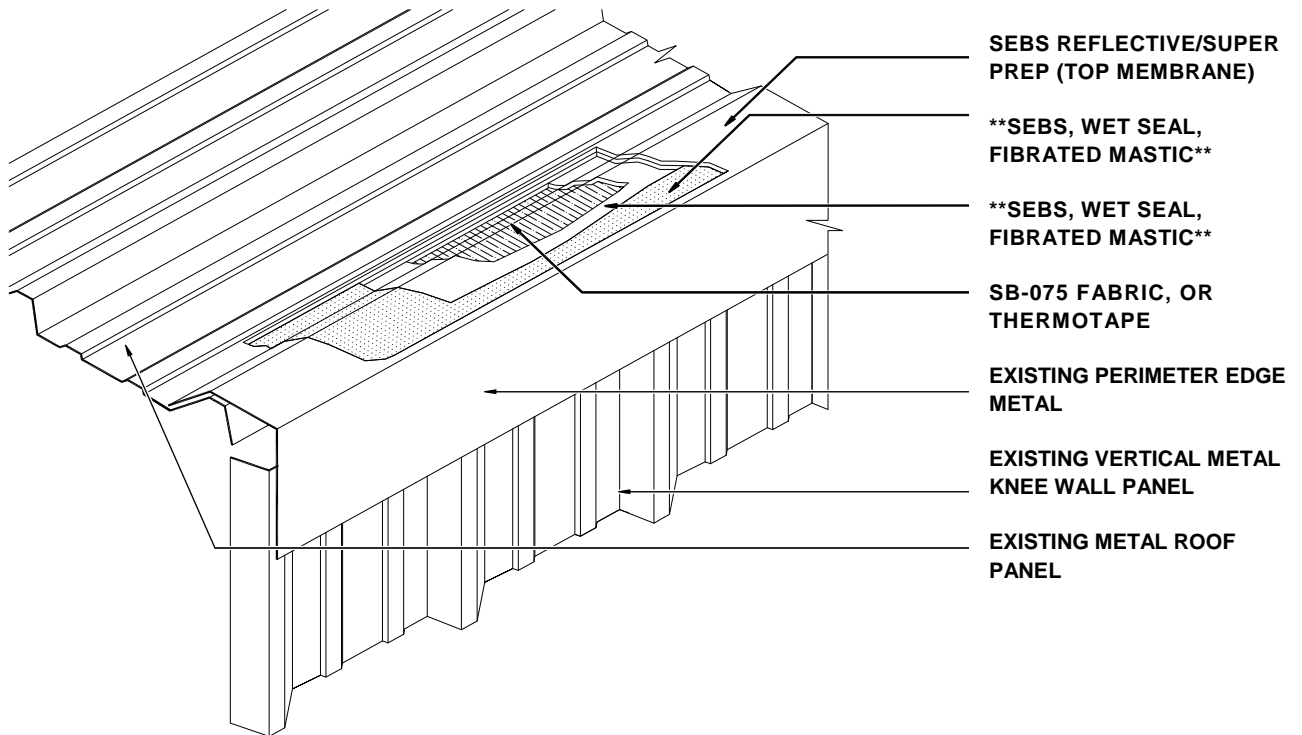

Since 1948  
Eco-friendly, Sustainable Building Restoration Specialists

### RAKE/EDGE-PERIMETER EDGE DETAIL



**NOT TO SPECIFIC SCALE**

**\*\*INDICATES THIS PRODUCT MUST BE APPLIED OVER A CLEAN/PREPARED SUBSTRATE PER SYSTEM GUIDE SPECIFICATIONS\*\***